

## SHAPE - W

## ALUMINIUM OXIDE

P/NO	SIZE (mm)		SHANK	APPLICATION (MATERIAL)
	D	L		
AW-W145	3	10	6mmØ x 30mm ( 1/4" Ø x 1-3/16" )	STEELS ALLOYED STEELS CAST IRON MALLEABLE IRON CAST STEEL
AW-W146	3	13		
AW-W154	5	12		
AW-W160	6	6		
AW-W163	6	13		
AW-W164	6	20		
AW-W168	8	8		
AW-W170	8	13		
AW-W177	10	20		
AW-W179	10	32		
AW-W185	13	13		
AW-W187	13	25		
AW-W188	13	38		
AW-W196	16	25		
AW-W204	20	20		
AW-W205	20	25		
AW-W208	20	50		
AW-W217	25	10		
AW-W220	25	25		
AW-W221	25	38		
AW-W225	32	6		
AW-W236	38	13		
AW-W237	38	25		
AW-W238	38	38		
AW-W242	50	25		



AW-W188



AW-W205



AW-W208



AW-W220

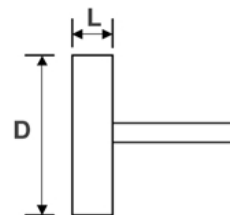
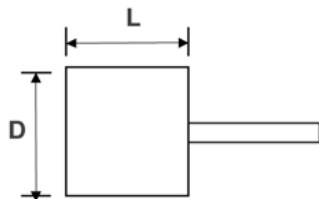
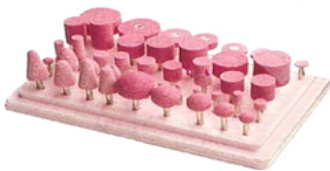

**ABRAWELD (S) PTE LTD**

No. 1 Upper Aljunied Link, Blk A, #08-06 Joo Seng Warehouse, Singapore 367901  
 Tel : +65 68586841 Fax : +65 68586842 email : [enquiry@abraweld.com.sg](mailto:enquiry@abraweld.com.sg)